





TABELA QUANTITATIVA: ESPÉCIES ARBÓREAS										
N° CÓDIGO		SÍMB.	NOME POPULAR	NOME CIENTÍFICO	CATEGORIA	ALTURA DAS MUDAS (m)	DIÂMETRO DAS COPAS ADULTAS (m)	ALTURA DAS ÁRVORES ADULTAS (m)	COVA DIM. (cm)	QUANTID. TOTAL (UNID.)
1	Tg		quaresmeira	<i>Tibouchina granulosa</i>	Arbóreo	2,0	6,0	10,0	70X70X80	01
2	Lg		palmeira—leque	<i>Licuala grandis</i>	Palmácea	2,0	2,0	3,6	70X70X80	01
3	Me		Acerola	<i>Malpighia emarginata</i>	Frutífera	2,0	4,0	5,0	70X70X80	02
4	Pg		Goiaba	<i>Psidium guajava</i>	Frutífera	2,0	4,0	6,0	70X70X80	02
5	Eu		Pitanga	<i>Eugenia uniflora</i>	Frutífera	2,0	6,0	6,0	70X70X80	02
									TOTAL	08







TABELA QUANTITATIVA: HERBÁCEAS ORNAMENTAIS/ARBUSTIVAS						
6	Ic		ixora	Ixora coccinea	1,50/1,50 m (espaçamento)	06 UN
7	Ap		alpinia	Alpinia purpurata	1,30/1,30 m (espaçamento)	07 UN
8	Gj		gardênia	Gardenia jasminoides	1,50/1,50 m (espaçamento)	05 UN
9	Pc		Bela Emília	Plumbago capensis	1,60/1,60m (espaçamento)	07 UN
10	Iw		lantana	Silves Compact	0,20/0,20 m (espaçamento)	1,27 m²
11	Cc		clorofito	Chlorophytum comosum	0,20/0,20 m (espaçamento)	10,79 m²

TABELA QUANTITATIVA: BENFEITORIAS		
	Piso cimentado (externo)	169,26 m²
	grama (interno)	150,04 m²

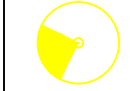

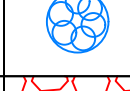
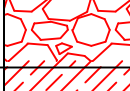

LOGATTI Engenharia Ltda. - EPP

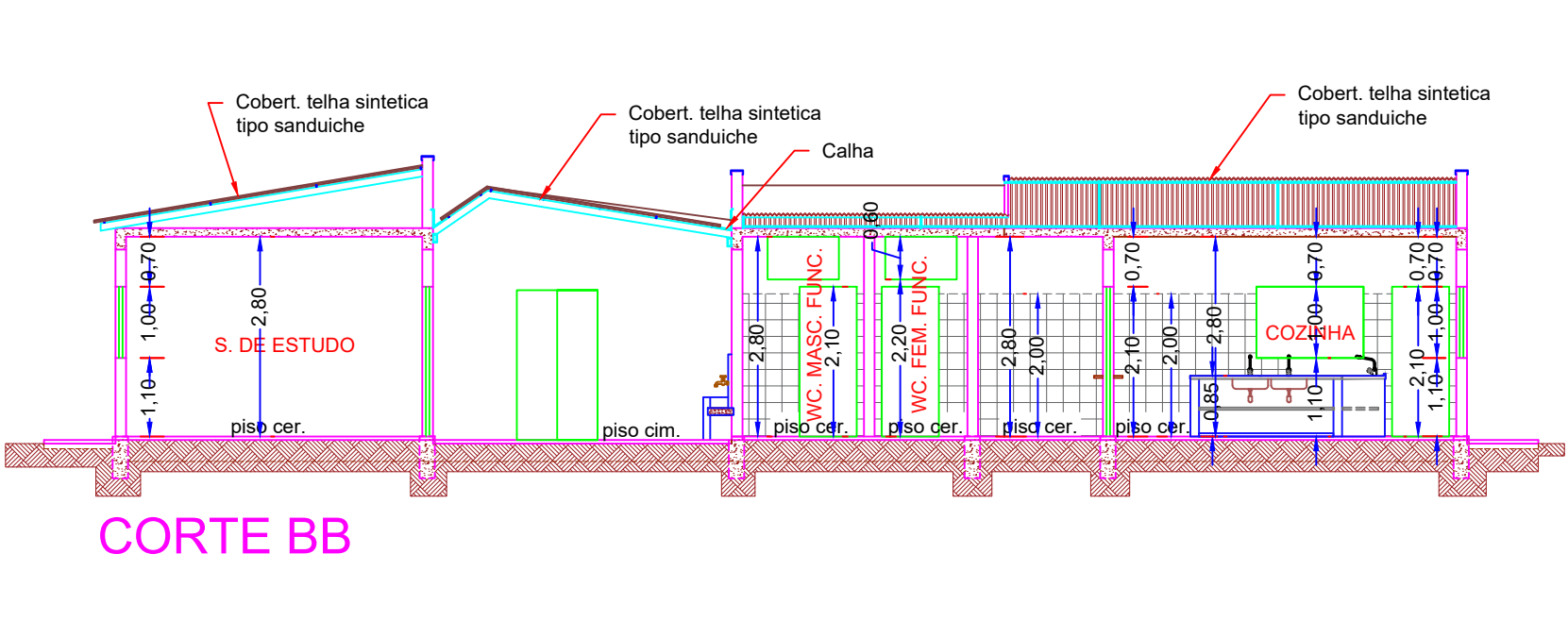
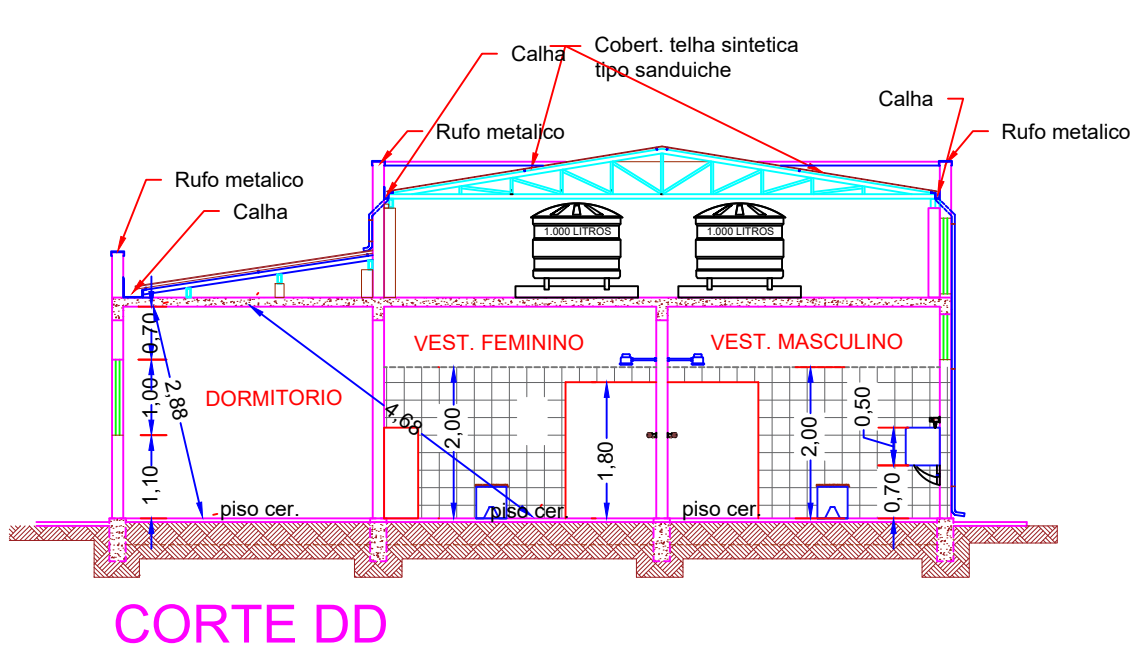
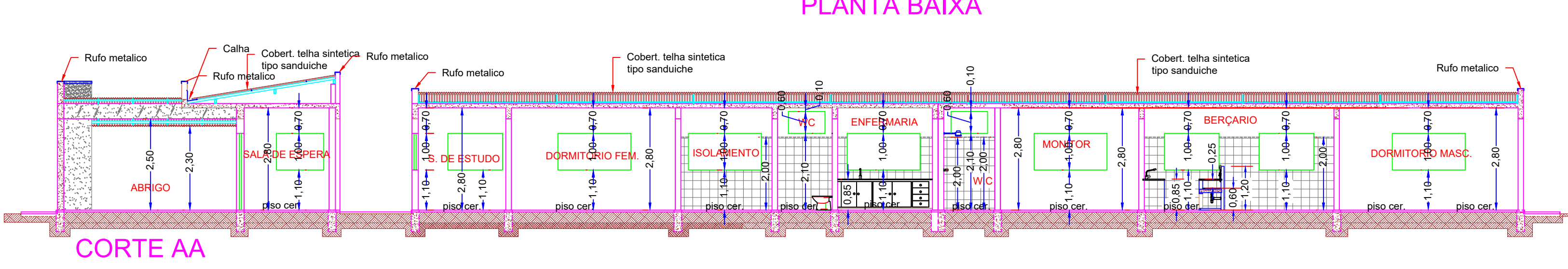
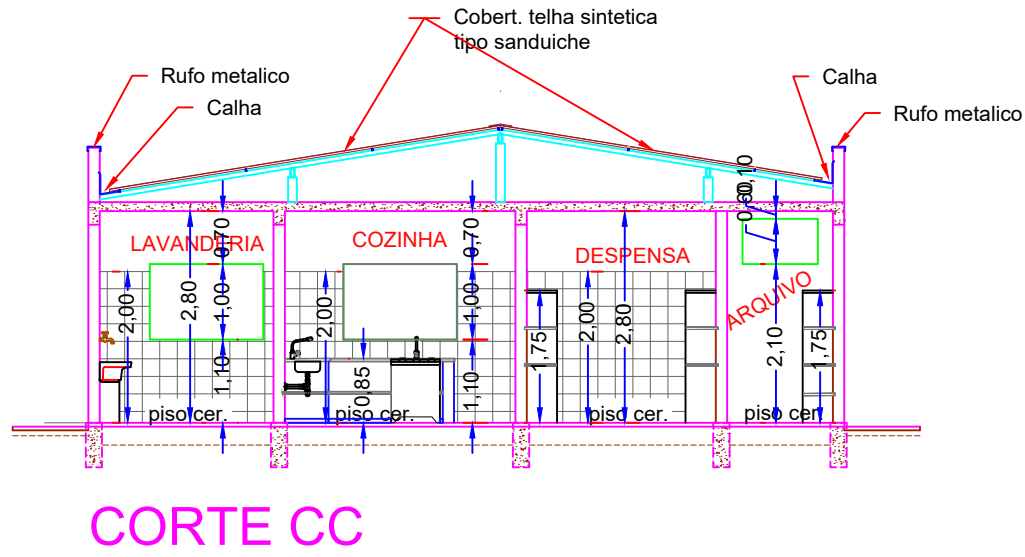
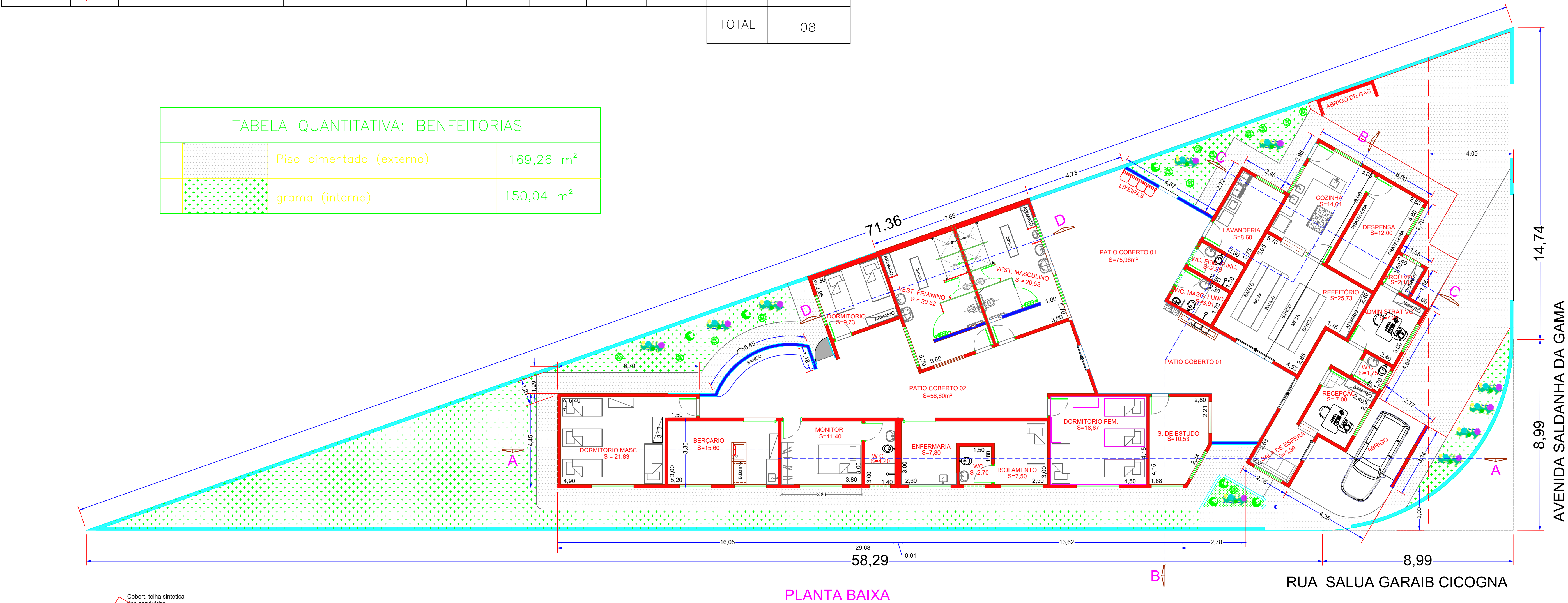
CNPJ 56.888.142/0001-91
Rua Imaculada Conceição, 1039 - Carmo
Telefone (16) 3332-3416

CEP. 14800-190, Araraquara - SP
logattitda@uol.com.br

COORDENAÇÃO / GESTÃO

ENGº FRANCISCO LOGATTI FILHO

CREA-600510807-SP

ART. 2620251775589

ART. 2620251775589

CORTES - PAISAGISMO

FL. 04/04

OBRA: Centro de Atendimento ao Menor

ASSUNTO: Cortes - Paisagismo

LOCAL: Rua Salua Garaib Cicogna, nº 113 - Quadra: A

BAIRRO: Parque Primavera

PROP: PREFEITURA DO MUNICÍPIO DE MATÃO

Autor do Projeto:

Eng.: Charles Alexandre Guellis
CREA: 5060906447

REVISÃO 01

10/09/2025